

Spaces at BE

The main indoor spaces available for performances are **The Studio**, **The Door** and **The House**. We are also able to programme outdoor work, promenade theatre and site-specific performances. We have previously programmed theatre in the festival restaurant (The House) and in the Hub. The Birmingham REP has a range of atmospheric spaces, each with its own opportunities.

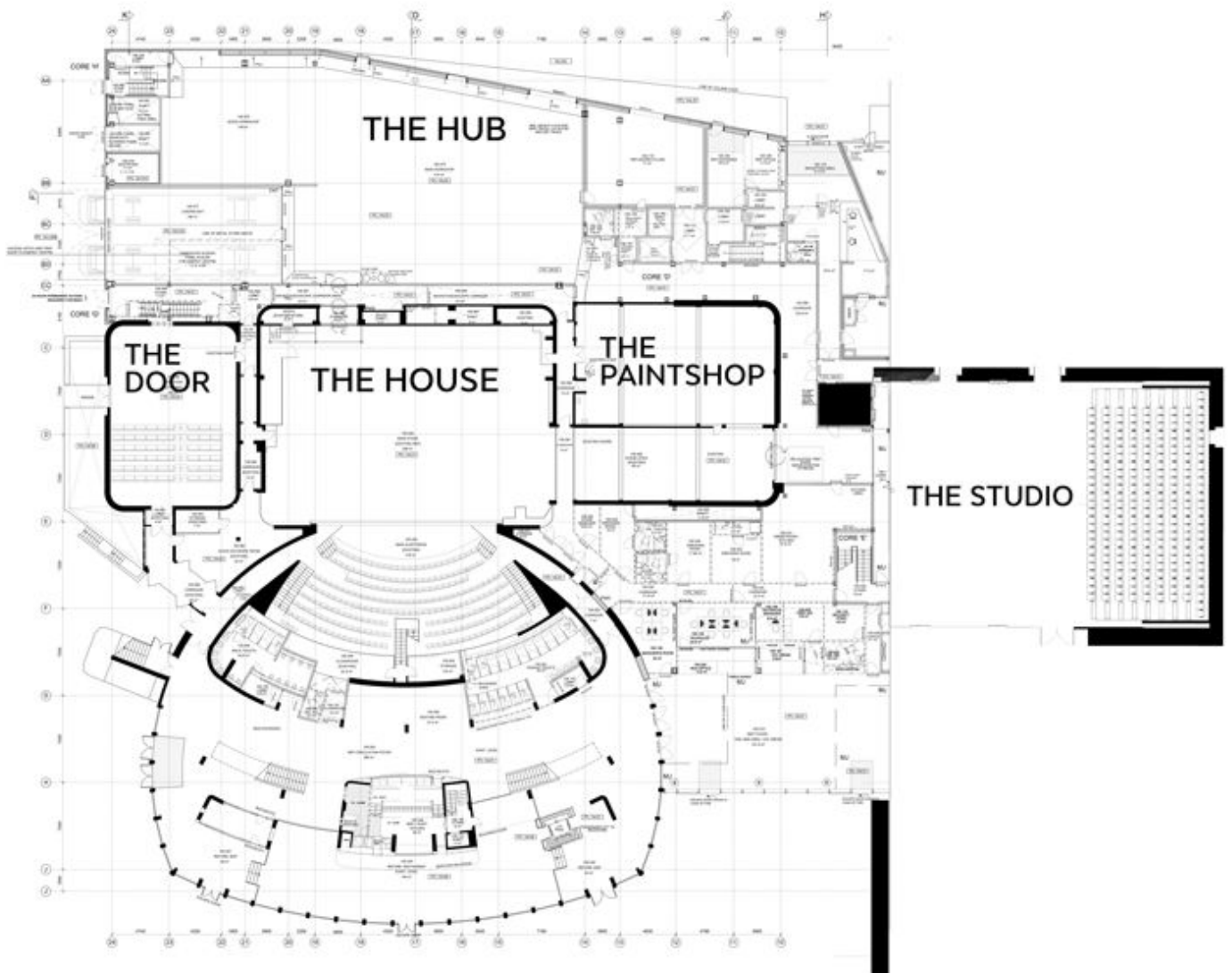



The Studio

The studio space has a seating capacity of 292, can achieve full blackout and has black dance flooring. There is also the capacity to remove the seating bank.

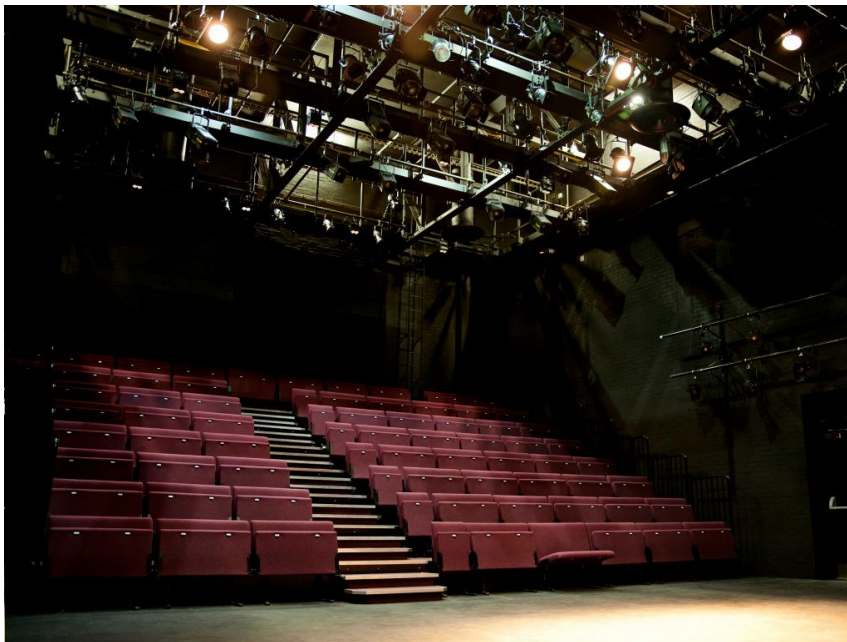

The Door

The Door is an end-on studio space with a seating capacity of 144. It can achieve full blackout and has a black dance floor.



The House

A large theatre with a seating capacity of 824. BE FESTIVAL usually uses the stage to serve the festival dinner. Companies have the possibility of using part of the stage blacked-out, the auditorium or performing during dinner.

We also have:



The Hub

An informal space filled with sofas, tables and a small stage – suitable for concerts, DJs, site-specific and cabaret performances.

